

TITAN Typ TC 1 10 kN

Hydraulic drum winch with 10 kN hoisting force

Performance data:

| TC 1 | Rope capacity | according to DIN 15020 ³ | | | | |
|---|---------------|-------------------------------------|-----------|-----------|----------|--------|
| | Rope layer | 1. | 2. | 3. | 4. | 5. |
| Hoisting force in kN, design according 1Bm ¹ | | 12,5 (11,5) | 11,5 (11) | 10,5 (10) | 10 (9,5) | 9 (x) |
| Rope length in m/layer, rope diam. 8 mm (M3) ² | | 10 (10) | 11 (12) | 12 (12) | 12 (13) | 13 (x) |
| Total rope length in m | | 10 (10) | 21 (22) | 33 (34) | 45 (47) | 58 (x) |
| Rope speed v in m/min, Qmax = 40 l/min | | 39 (42) | 43 (45) | 46 (48) | 50 (52) | 53 (x) |

¹ gear according to FEM 9.511

² rope diameter according FEM 5.013

³ drum core diameter according to
DIN 15020

figures in brackets are valid with grooved
drum option. (X) layer not available with
grooved drum option.

- diff. pressure at hoisting force (1Bm)
10 kN = 170 bar dyn., 220 bar stat.
return flow pressure 10 bar in consideration.

Recommendation:

- installation must be carried out according to the
guidelines for ROTZLER TITAN hoisting winches!
- weight of the winch approx. 50 kg.
- for this winch we recommend a rotation resistant rope,
cross lay to the right.
- rope diameter: 8 mm recommended, 5 - 10 mm possible.
- the last three windings of cable must always remain on
the drum for safety reasons.
- this winch must not be used for personnel
transportation.



Standard version:

- incl. planetary gear box
- incl. hoisting free wheel
- incl. hydraulically released brake
- incl. hydraulic motor
- incl. counter balance valve
- sea water protected

Optional:

- MCD: control functions inc.
rope end and torque control

Our competence:

- design acc. DIN and FEM
- compact design
- low weight
- compact installation
- high quality
- up to date technology
- high operation safety
- precise operation
- easy to maintain
- long working life
- compact hoisting winch
especially designed for
modern loader cranes

TITAN Typ TC 1 10 kN

General dimensions:

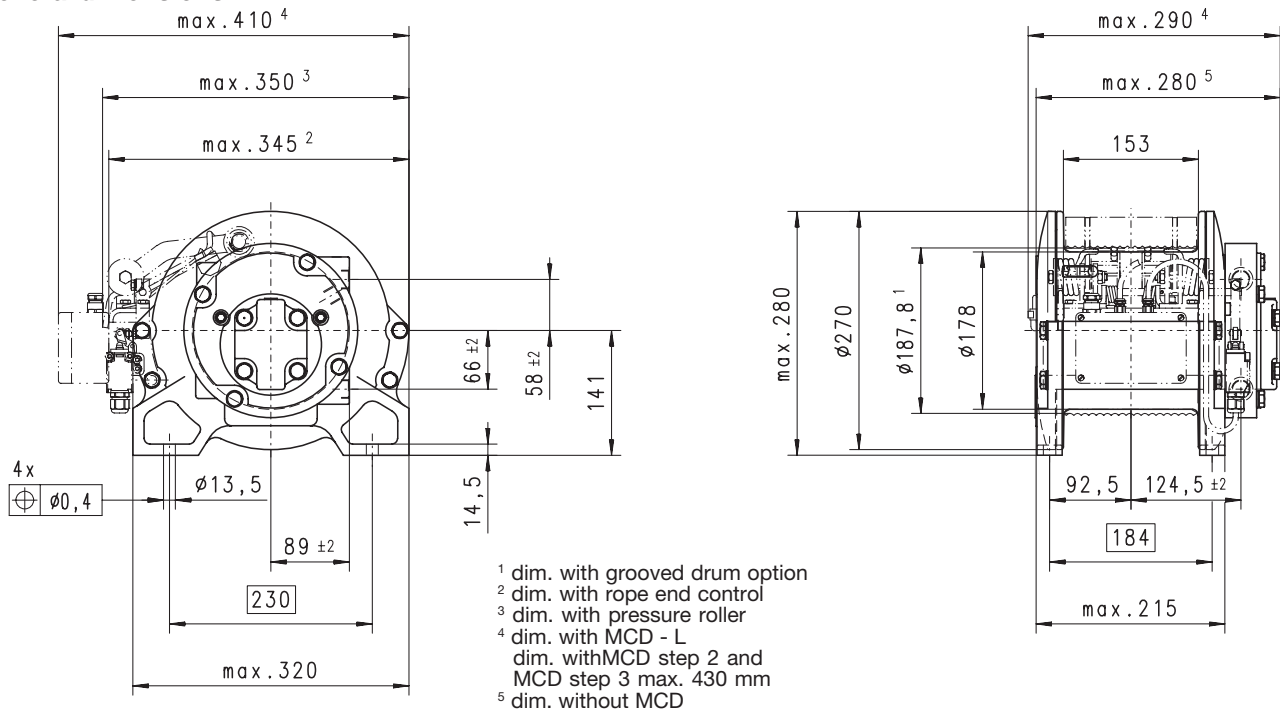

Order coding system (valid since 31.01.2003)

1 . TC 010 . CW . 0 . 0 . 0 . 0

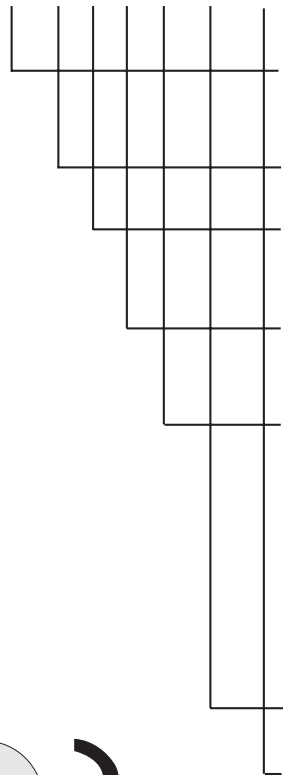

direction of rotation¹

CW clockwise
CC counter clockwise

motor type

0 - standard motor (standard)

drum

0 - standard drum
1 - large drum⁴

grooving

0 - without grooving (standard)
1 - special grooving⁴

MCD

0 - without (Standard)
1 - MCD Step 1 : rope end control
2 - MCD Step 2 : rope end control and 1-pt-torque
3 - MCD Step 3 : rope end control and 2-pt-torque
4 - MCD - L : rope end and torque control (linear signal)

adjustment hoisting force first point (1. layer)²

adjustment hoisting force second point (1. layer)³

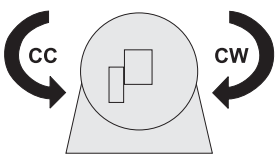

¹ in each case view to the motor side

² only with control function 1pt torque control and MCD-L

³ only with control function 2pt torque control

⁴ not available in the moment

ROTZLER GMBH + CO. KG

Winches, Capstans and Winch Systems, P.O. Box 1165, D - 79577 Steinen

Tel. +49 7627/701-0, Fax +49 7627/701-198, www.rotzler.com, info@rotzler.de